

## Unpacking

Please make sure the package contains the following items:

 Screw fixing seat x 2
  ST4X20 screw x 2
  M4X30 screw x 2



11 Pin cable x 1



Wall bracket x 1



10 Pin cable x 1  
(Except C313N)



C313X x 1

## Product Overview

### Front Panel

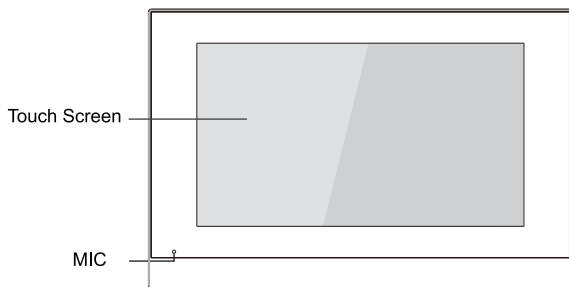

C313X

### Rear Panel

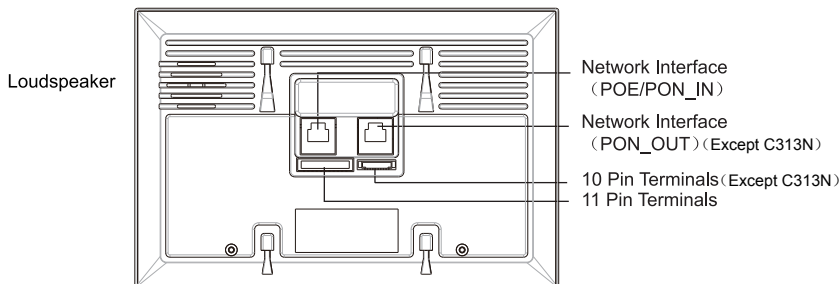

\*NOTE:C313N does not have PON\_OUT Interface.

## Installation

### Without 86 embedded box in the wall

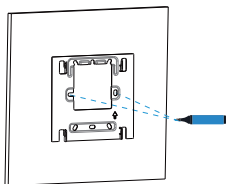

Mark two fixation holes through wall bracket on the wall, the distance between which is 60mm. Make sure the all cables can be passed from the middle of wall bracket.

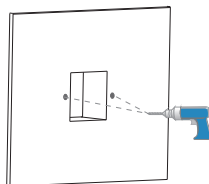

Take down the bracket, then using a 5mm hand drill to make the two fixation holes on the wall you marked before.

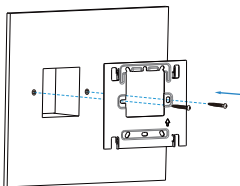

Use two ST4X20 screws to fix the wall bracket on the wall.

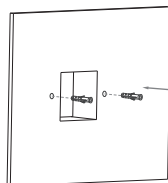

Once the fixation holes are made, insert the two screw fixing seats provided.

### With 86 embedded box in the wall

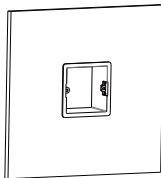

Make sure all cables in the 86 embedded box.

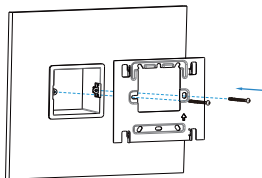

Fix the wall bracket on the 86 embedded box with two M4X30 screws.

# C313X Quick Guide

## Device Mounting

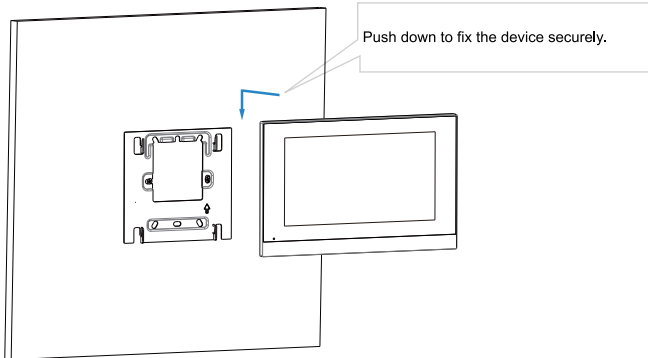



## Configuration

1. After setting up network and power, press Status icon to check IP address (DHCP by default).
2. Launch web browser and type in the IP address to access web interface, login with username and password. (admin by default).
3. Register the device with your SIP account. (please refer to user manual for more information).

## Operation

### Make a call

Press Intercom key  , enter the callee's number or room address , then choose Audio  or Video  mode to call out.

### Receive a call

When receiving a video call, users can choose Audio or Video mode to answer. However, if there is an audio call, users can only press Audio mode to pick up.

### Unlock

During the talk, press the Open Door key **Open Door** in talking interface to unlock the door.

### Monitor

Press Monitor key  to receive the video from indoor IPC or community IPC any time.

### SOS

Press SOS key **SOS** in case of an emergency.

## Device Wiring

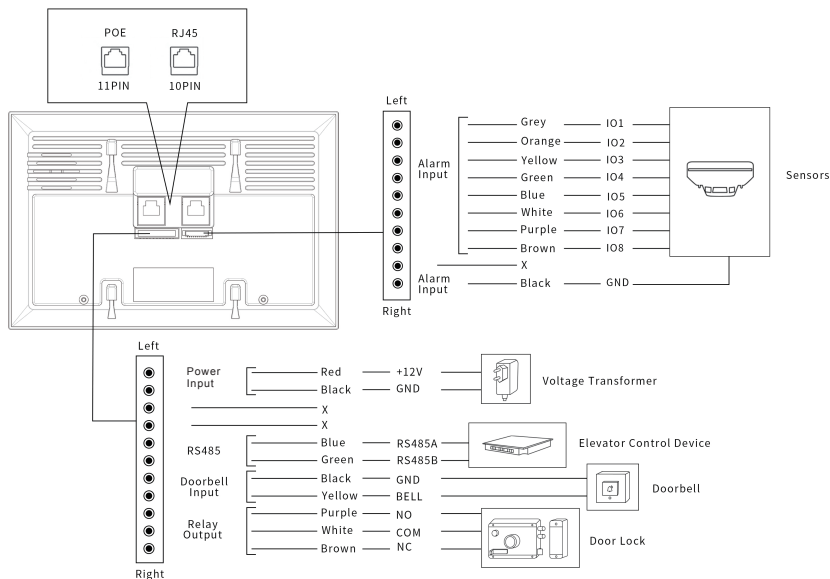

### Notice Information

Akuvox C313X firmware contains third-party open source software under the terms of the GNU General Public License(GPL). Akuvox is committed to meeting the requirements of the GNU General Public License (GPL) and will make all required source code available.

The source code of software under the terms of GNU GPL can be downloaded online: <http://www.akuvox.com/gpl>.

Information contained in this document is believed to be accurate and reliable at the time of printing. This document is subject to change without notice, any update to this document can be viewed on Akuvox' s website: <http://www.akuvox.com> © Copyright 2019 Akuvox Ltd. All rights reserved.



**AKUVOX (XIAMEN) NETWORKS CO., LTD.**

ADD: 10/F, NO.56 GUANRI ROAD, SOFTWARE PARK II, XIAMEN 361009, CHINA  
[www.akuvox.com](http://www.akuvox.com)

